

Inserts

Conventional

OEC Type

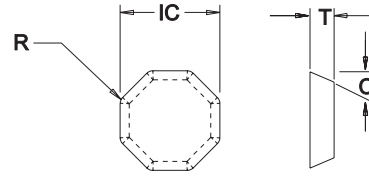

for "450" Series cutters

Insert Dimensional & Grade Specifications

Insert Number	IC	T	R	C	Coated Grades					Uncoated Grades		
					586XRm	606jRm	LT-50	LT-45	LT-40	LTC-21	LTC-14	LTC-10
OEC-634	0.750	0.188	0.062	20°	●●●●	●						
OEC-634W520	0.750	0.188	0.062	20°	●●●	●			●			

OECH Type

for "XR" Series cutters

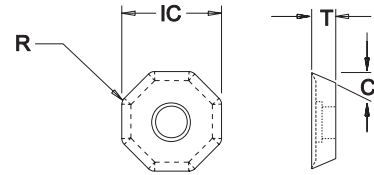
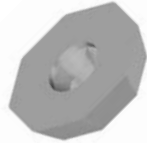
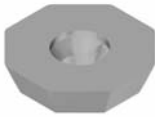

Insert Dimensional & Grade Specifications

Insert Number	IC	T	R	Geometry	C	Coated Grades				Uncoated Grades			
						586XRm	606jRm	LT-50	LT-40	LTC-21	LTX	LTC-14	LTC-10
OECH-432	0.500	0.188	0.032	Flat	23°					●●●●			●●
OECH-432-10F	0.500	0.188	0.032	+10° Dish	23°	●●●●							●●
OECH-432W520	0.500	0.188	0.032	Flt. w/land	23°	●●●	●					●	
OECH-534-10F	0.625	0.188	0.062	+10° Dish	23°	●●●●	●		●	●●		●	●●
OECH-534W520	0.625	0.188	0.062	Flt. w/land	23°	●●●	●		●			●	
OECH-634-10F	0.750	0.188	0.062	+10° Dish	23°	●●●●	●		●	●●		●	●●
OECH-634W520	0.750	0.188	0.062	Flt. w/land	23°	●●●	●		●			●	

- All Materials
- Cast Iron
- Hardened Materials
- Steel
- Aluminum / Non-Ferrous
- Stainless Steel
- Heat Resistant Super Alloys

