

GXSMH Series

(for Flat Bottom Only)

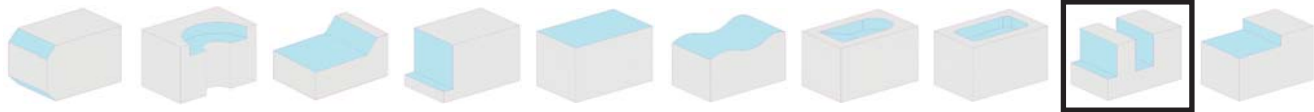

Slotting Cutter .500 Insert



• Adjustable Widths

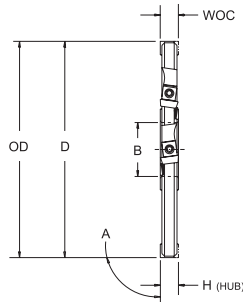

8° Pos Axial Pos Radial 90° Shldr

• GXSMH uses .500 FPE insert for true flat bottom ONLY!

GXSMH Series - Dimensional Specifications

Product Number	D	OD	B	H	A	WOC	Insert	Teeth	Weight
4GXSM8H-5H	4.00	4.00	1.25	.500	90°	.510-.562	FPE-43__	8	3.00
5GXSM8H-6H	5.00	5.00	1.50	.500	90°	.510-.562	FPE-43__	10	3.25
6GXSM8H-6H	6.00	6.00	1.50	.500	90°	.510-.562	FPE-43__	12	3.50
8GXSM8H-8H	8.00	8.00	2.00	.500	90°	.510-.562	FPE-43__	16	3.75
10GXSM8H-8H	10.00	10.00	2.00	.500	90°	.510-.562	FPE-43__	20	4.00
4GXSM9H-5H	4.00	4.00	1.25	.562	90°	.562-.625	FPE-43__	8	3.25
5GXSM9H-6H	5.00	5.00	1.50	.562	90°	.562-.625	FPE-43__	10	3.75
6GXSM9H-6H	6.00	6.00	1.50	.562	90°	.562-.625	FPE-43__	12	4.00
8GXSM9H-8H	8.00	8.00	2.00	.562	90°	.562-.625	FPE-43__	16	4.25
10GXSM9H-8H	10.00	10.00	2.00	.562	90°	.562-.625	FPE-43__	20	4.50
4GXSM10H-5H	4.00	4.00	1.25	.625	90°	.625-.687	FPE-43__	8	3.50
5GXSM10H-6H	5.00	5.00	1.50	.625	90°	.625-.687	FPE-43__	10	3.75
6GXSM10H-6H	6.00	6.00	1.50	.625	90°	.625-.687	FPE-43__	12	4.00
8GXSM10H-8H	8.00	8.00	2.00	.625	90°	.625-.687	FPE-43__	16	4.25
10GXSM10H-8H	10.00	10.00	2.00	.625	90°	.625-.687	FPE-43__	20	4.50
4GXSM11H-5H	4.00	4.00	1.25	.687	90°	.687-.750	FPE-43__	8	3.75
5GXSM11H-6H	5.00	5.00	1.50	.687	90°	.687-.750	FPE-43__	10	4.00
6GXSM11H-6H	6.00	6.00	1.50	.687	90°	.687-.750	FPE-43__	12	4.25
8GXSM11H-8H	8.00	8.00	2.00	.687	90°	.687-.750	FPE-43__	16	4.50
10GXSM11H-8H	10.00	10.00	2.00	.687	90°	.687-.750	FPE-43__	20	4.75
4GXSM12H-5H	4.00	4.00	1.25	.750	90°	.750-.812	FPE-43__	8	2.50
5GXSM12H-6H	5.00	5.00	1.50	.750	90°	.750-.812	FPE-43__	10	2.75
6GXSM12H-6H	6.00	6.00	1.50	.750	90°	.750-.812	FPE-43__	12	4.25
8GXSM12H-8H	8.00	8.00	2.00	.750	90°	.750-.812	FPE-43__	16	4.75
10GXSM12H-8H	10.00	10.00	2.00	.750	90°	.750-.812	FPE-43__	20	5.25

Insert I.C. x Thickness					
.500 X .188	Insert Pg. 34 FPE-43__	Insert Lock 1570	Lock Screw 1573	Adjusting Screw 1365	Lock Screw Wrench 1557-PT8

Machining Parameters

Material	SFPM	FPT	Primary	Secondary
Gray Cast Iron, Class 30	200-500	.002-.008	FPE-432 GR LT-45	FPE-432 GR LTC-83
Tool Steel, D2	250-350	.002-.008	FPE-432B GR LT-50	FPE-432 GR LT-40
Medium Alloy Steel	300-700	.002-.008	FPE-432 GR LT-40	FPE-432B GR LT-50
Tool Steel, P20	300-700	.002-.008	FPE-432 GR LT-40	FPE-432 GR LTC-14
Soft Alloy Steel	400-800	.002-.008	FPE-432 GR LT-40	FPE-432 GR LTC-14
Stainless Steel, 17-4PH, 15-5PH	300-700	.002-.008	FPE-432 GR LT-40	FPE-432 GR LTC-14
Stainless Steel, 304, 316	200-500	.002-.008	FPE-432 GR LT-45	FPE-432 GR LTC-83

- Free cutting positive geometry designed for a broad range of workpiece materials
- High production design includes offset drive keys for multiple tool “gang” setups
- Engineered with generous chip gullets to ensure optimum chip evacuation
- Adjustable widths ensure infinite coverage between .510” and .812” in each GXSMH diameter
- Engineered for stability over a variety of applications



Index

Specials

Inserts

General

Cavity Mold

Gray Iron

PCD / CBN

Slotters

Technical Data

Holders