

290 Series

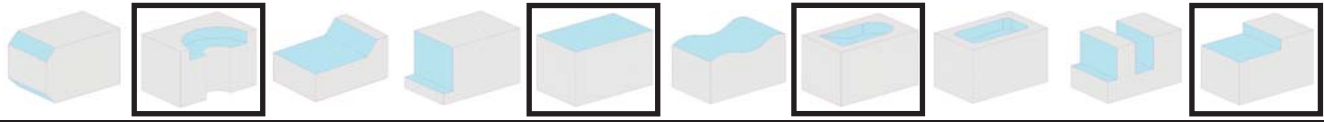

Index

Specials

Inserts

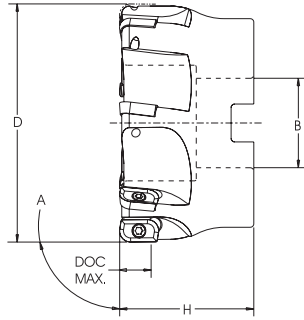

7° Axial Pos Radial 0° Lead - Face Mill
7° Axial Neg Radial 0° Lead - End Mill

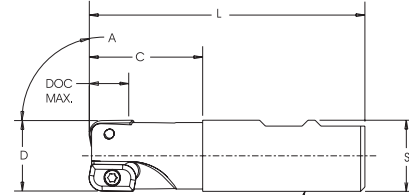

• Square Shoulder • Ramping Capability

• Extended Reach • Square Shoulder • Ramping Capability

• End Mills with Thru Coolant Capability

General

Cavity Mold

Gray Iron

PCD / CBN

Slotters

Technical Data

Holders

290 Series - Dimensional Specifications

Face Mills

Product Number	D	B	H	A	DOC	Insert	Teeth	Weight
290F0200ACP3-075R	2.00	0.75	2.25	90°	.61	CPEH-32.63-__4W	5	1.75
290F0250ACP3-075R	2.50	0.75	2.25	90°	.61	CPEH-32.63-__4W	6	2.75
290F0300ACP3-100R	3.00	1.00	2.25	90°	.61	CPEH-32.63-__4W	6	4.00
290F0400ACP3-150R	4.00	1.50	2.25	90°	.61	CPEH-32.63-__4W	8	6.75

End Mills

Product Number	D	S	C	L	A	DOC	Insert	Teeth	Weight
290E0100ACP3-W100R	1.00	1.00	1.60	3.88	90°	.61	CPEH-32.63-__4W	2	0.88
290E0100BCP3-W100R	1.00	1.00	3.00	5.28	90°	.61	CPEH-32.63-__4W	2	1.25
290E0100CCP3-W100R	1.00	1.00	4.00	6.28	90°	.61	CPEH-32.63-__4W	2	1.50
290E0100DCP3-W125R	1.00	1.25	5.00	7.28	90°	.61	CPEH-32.63-__4W	2	1.88
290E0100ECP3-W125R	1.00	1.25	6.00	8.28	90°	.61	CPEH-32.63-__4W	2	2.00
290E0125ACP3-W100R	1.25	1.00	1.60	3.88	90°	.61	CPEH-32.63-__4W	3	1.00
290E0125BCP3-W125R	1.25	1.25	3.00	5.28	90°	.61	CPEH-32.63-__4W	3	2.00
290E0125DCP3-W125R	1.25	1.25	5.00	7.28	90°	.61	CPEH-32.63-__4W	3	2.50
290E0150ACP3-W100R	1.50	1.00	1.60	3.88	90°	.61	CPEH-32.63-__4W	4	1.25
290E0150ACP3-W125R	1.50	1.25	1.60	3.88	90°	.61	CPEH-32.63-__4W	4	1.50
290E0150BCP3-W125R	1.50	1.25	3.00	5.28	90°	.61	CPEH-32.63-__4W	4	2.25
290E0150DCP3-W125R	1.50	1.25	5.00	7.28	90°	.61	CPEH-32.63-__4W	4	3.25
290E0200ACP3-W125R	2.00	1.25	1.60	3.88	90°	.61	CPEH-32.63-__4W	5	2.25
290E0200CCP3-W200R	2.00	2.00	4.00	7.25	90°	.61	CPEH-32.63-__4W	5	6.50
290E0200ECP3-W200R	2.00	2.00	6.00	9.25	90°	.61	CPEH-32.63-__4W	5	8.25

Insert I.C. x Thickness	Insert Pg. 31	Insert Screw	Insert Screw Wrench
.375 x .188	CPEH-32.63-2-4W CPEH-32.63-4-4W CPEH-32.63-6-4W CPEH-32.63-8-4W CPEH-32.63-12-4W	3605-0001-0033	1557-TX15

Machining Parameters

Material	SFPM	FPT	Primary	Secondary
Tool Steel, D2, P20	300-700	.003-.010	CPEH-32.63-__-4W GR 606jRm	CPEH-32.63-__-4W GR LTC-14
Stainless Steel 300 Series	300-600	.003-.008	CPEH-32.63-__-4W GR 586XRm	CPEH-32.63-__-4W GR LTC-10

- Chip control insert for optimum tool performance
- Large chip gullets
- Large offering of insert corner radii
- Extended length tools for long reach applications